

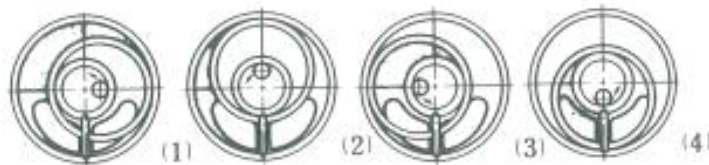

DY FLOWTECH Inc.

(DONG YANG INS.)

ROTARY PISTON FLOW METER DY-OR SERIES



Manufactured Since 1988

GENERAL SPECIFICATION

○ APPLICATION

- ◇ Flow measurement for fuels and chemical liquid.
- ◇ Chemical and Food industry.
- ◇ Vessel's burners.

○ FEATURES

- ◇ High Accuracy $\pm 0.5\%$
- ◇ High Temp. and pressure up to 180°C, 20Kg
- ◇ Easy to read digital and analog display
- ◇ High, Low speed pulse signal output
- ◇ Low cost and Long life

○ BASIC METER

Normal Size	20, 25, 40, 50, 65, 80, 100mm	
Accuracy	within $\pm 0.5\%$	
Max operating pressure	10Kg(standard)	
Max operating temperature	70°C, 100°C, 120°C	
Flange rating	ANSI #150, JIS10Kgf/cm ² , JIS20Kgf/cm ² , DIN 16bar ect.	
Material	Meter body	FC200, SUS304,
	Rotor	Aluminium, SUS304
Display	Totalizing counter	11-digit LCD
	Reset counter	6-digit LCD
	Analog counter	4-digit and 8-digit
Power	Lithium battery, DC24V,	
Output	Pulse, 4~20mA analog (analog counter type only available Pulse)	

○ MODEL CODE

Model	size	Max Temp	Mat'l	Display	Connection	Description
OR						
	1					70°C (Rotor : AL)
	2J					100°C (Rotor : AL)
	3SJ					120°C (Rotor : SUS304)
			A			Body : FC200 (DN20~DN100)
			B			Body : SUS304 (DN20~DN100)
				0		6 digit Flowrate/11 digit Totalizer (Battery type)
				1		6 digit F/R /11 digit Totalizer/Pulse (Battery type)
				2		6 digit F/R /11 digit Totalizer/Pulse (DC24V)
				3		6 digit F/R /11 digit Totalizer/4-20mA (DC24V)
				4		6 digit F/R /11 digit Totalizer/4-20mA (AC220V)
				5		Analog type
					J10	JIS 10K
					J20	JIS 20K
					P16	PN16
					P25	PN25
					P40	PN40

○ FLOW RANGE (BASIC OPTION)

Model	Size(mm)	Flow range(m ³ /H)
DYOR 20	20	0.1 ~ 1
DYOR 25	25	0.3 ~ 3
DYOR 40	40	0.6 ~ 6
DYOR 50	50	1.2 ~ 12
DYOR 65	65	1.8 ~ 18
DYOR 80	80	3 ~ 30
DYOR 100	100	4 ~ 40

○ DIMENSION

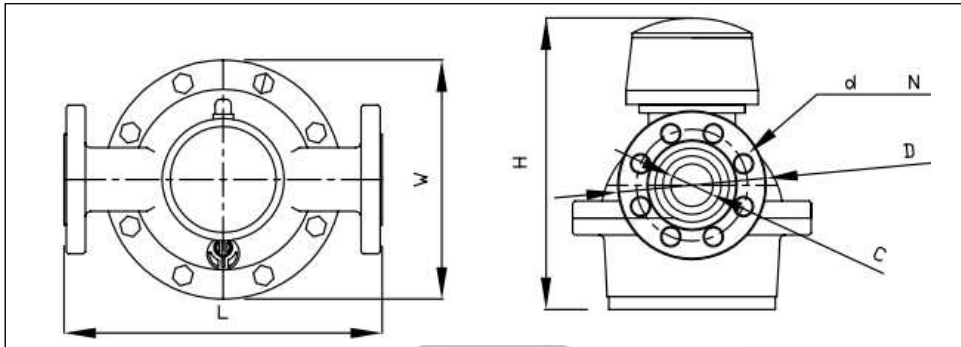

Model	L	H	High Temp	W	D	c	d	N
DYOR 20	195	185	+90	125	100	27.7	15	4
DYOR 25	270	235		165	125	34.5	19	4
DYOR 40	300	270		230	140	49	19	4
DYOR 50	370	290		270	155	61	19	4
DYOR 65	370	290		270	175	77	19	4
DYOR 80	440	330		350	185	90	19	8
DYOR 100	440	330		350	210	115.4	19	8

Above dimension is for JIS10K standard.

○ INSTALLATION

- Indicator's direction must be on the top.
- must install the strainer in front of flow meter.
- Do clean the pipeline before installing the meter.
(Dirt and particles inside the piping cause problem to the flowmeter.
Take special care when installing to new piping,
because new piping may have welding debris.)
- Avoid humid places.

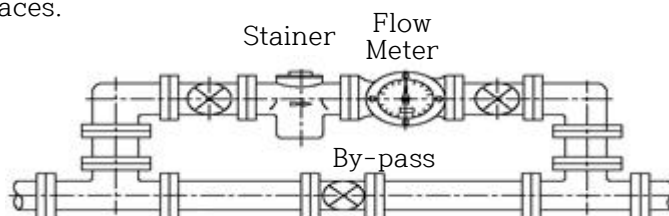

allow a minimum straight pipe length at least 10 times the internal diameter of the pipe.
For example, with the 50mm pipe, there should be 500mm of straight pipe immediately upstream.

Desired upstream straight pipe length is 1000mm.